

# **A66 Northern Trans-Pennine Project**

**Scheme 0102: M6 Junction 40 to Kemplay Bank**

**TR010062**

## **General Scheme Outline Plans**

**Response to ExA's Procedural Decision PD-006 in Rule 6 Letter**

**Nov 2022**

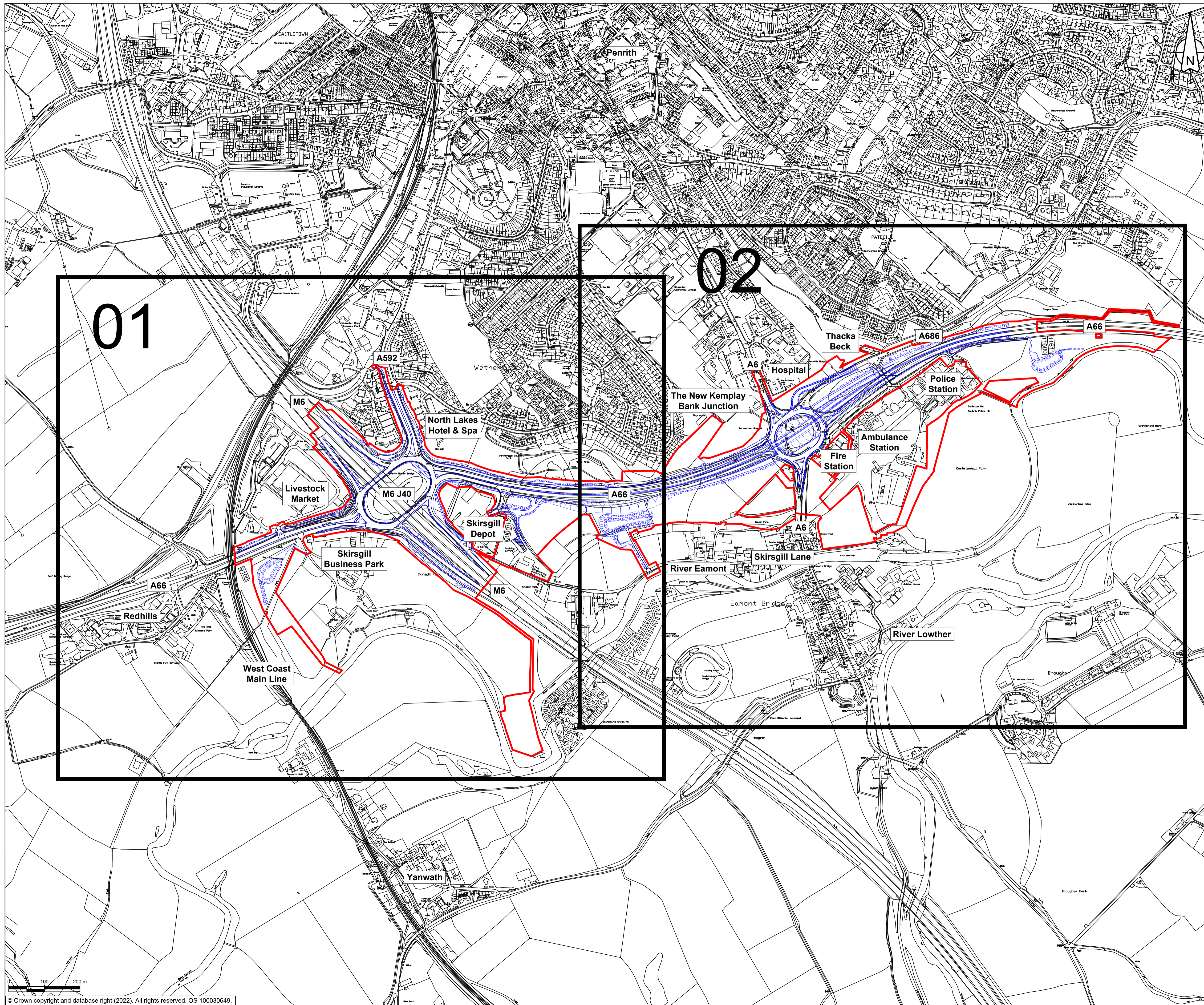

- NOTES**  
 1. ALL DIMENSIONS ARE IN METRES UNLESS NOTED OTHERWISE.
- KEY**
- THE SCHEME (SHOWN FOR ILLUSTRATIVE PURPOSES ONLY)
  - SHEET USED AS PART OF THIS DRAWING SERIES
  - CHAINAGE (MEASURED DISTANCE ALONG THE SCHEME LENGTH)
  - ORDER LIMITS

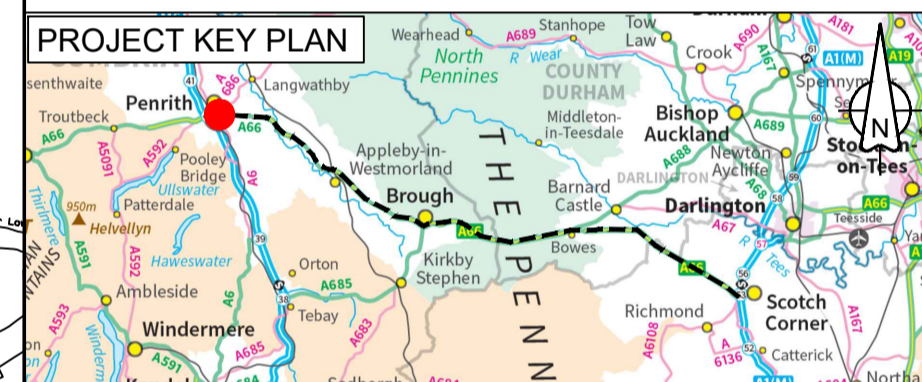

C01	ASCO	ASCO	JJAS	DKID	SBAG
	14/11/22	14/11/22	14/11/22	14/11/22	14/11/22
Revision details					
Revision	Created	Checked	Reviewed	Approved	Authorised
	dd/mm/yy	dd/mm/yy	dd/mm/yy	dd/mm/yy	dd/mm/yy

Purpose  
 Response to ExA's Procedural Decision PD-006 in Rule 6 Letter

PINS Reference Number  
 TR010062

Client  
 3 Piccadilly Place  
 Manchester  
 M1 3BN



Project Name / Scheme Name  
**A66 Northern Trans-Pennine Project  
 Scheme 0102  
 M6 Junction 40 to Kemplay Bank**

Drawing Title  
**General Scheme Outline Plans  
 Submitted in response to PD-006  
 Key Plan**

Project Ref. No.	Stage	Scale :	@ A1
---	PCF3	1:5000	
		Dimensions :	M

Drawing Number	Project	Originator	Volume
HE565627	- AMY	- HAC	-
S0102	-DR-CH-	000002	
Location	Type	Role	Number

Suitability	Suitability Description	Revision
A	Approved for Stage Complete	C01

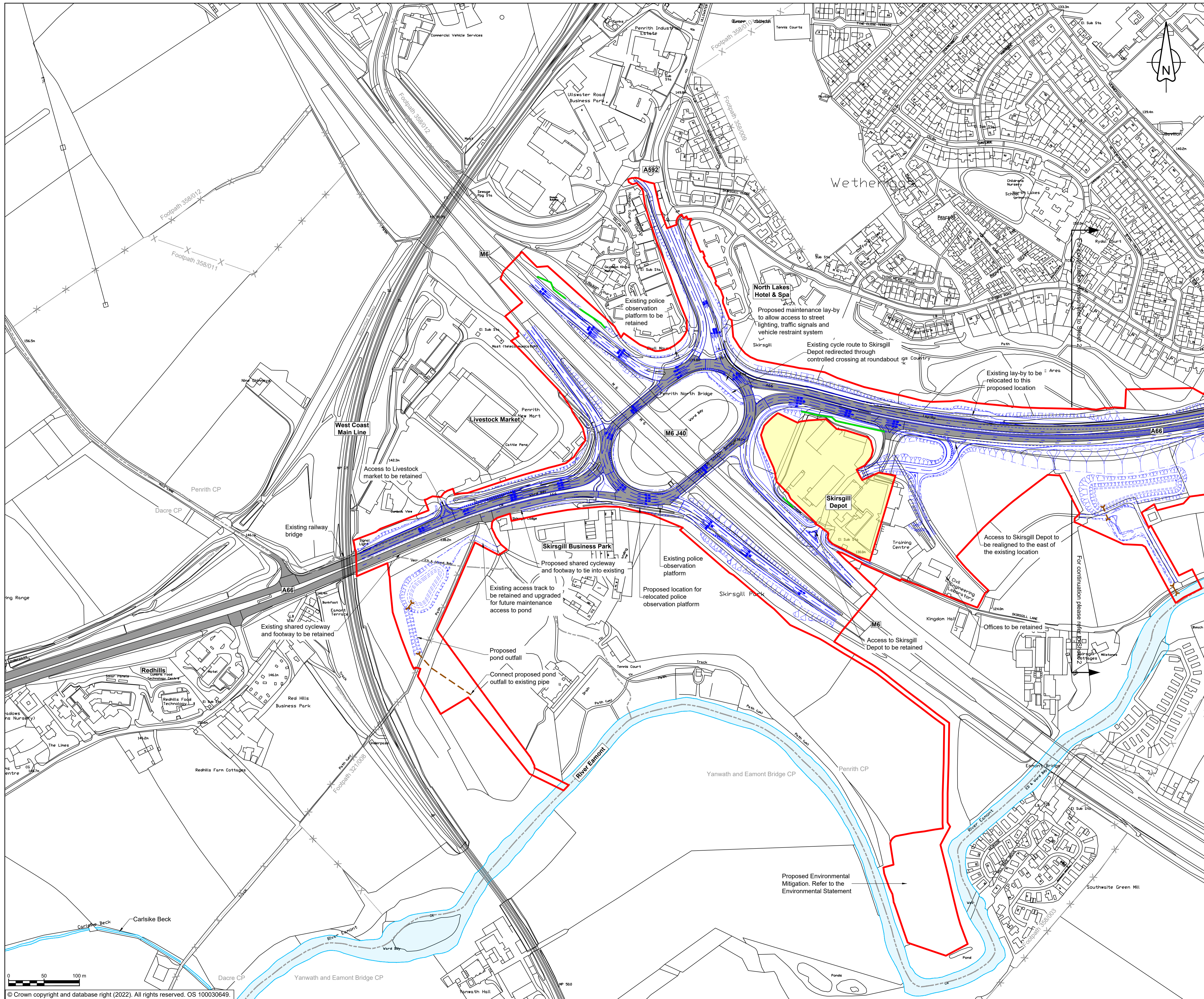

- ### NOTES
1. ALL DIMENSIONS ARE IN METRES UNLESS NOTED OTHERWISE.
  2. FOR ENVIRONMENTAL DETAILS REFER TO THE ENVIRONMENTAL MASTERPLAN AND ASSOCIATED DRAWINGS/DOCUMENTS.
  3. THE DESIGN OF THE SCHEME IS SHOWN HERE FOR ILLUSTRATIVE PURPOSES ONLY AND WILL BE SUBJECT TO DETAILED DESIGN DEVELOPMENT IN ACCORDANCE WITH THE PROVISIONS OF THE DEVELOPMENT CONSENT ORDER.
  4. THESE PLANS SHOULD BE READ IN CONJUNCTION WITH RIGHTS OF WAY AND ACCESS PLANS.

- ### KEY
- ORDER LIMITS
  - AREA EXCLUDED FROM ORDER LIMITS
  - AREA OF OUTSTANDING NATURAL BEAUTY (AONB)
  - EXISTING WATERCOURSE
  - EXISTING A66 CARRIAGEWAY
  - PARISH BOUNDARY
  - EXISTING PUBLIC RIGHT OF WAY
  - PROPOSED WORKS
  - PROPOSED EARTHWORKS
  - PROPOSED CULVERT & HEADWALL
  - PROPOSED RETAINING STRUCTURE
  - PROPOSED BRIDGE / VIADUCT
  - PROPOSED UNDERPASS / TUNNEL

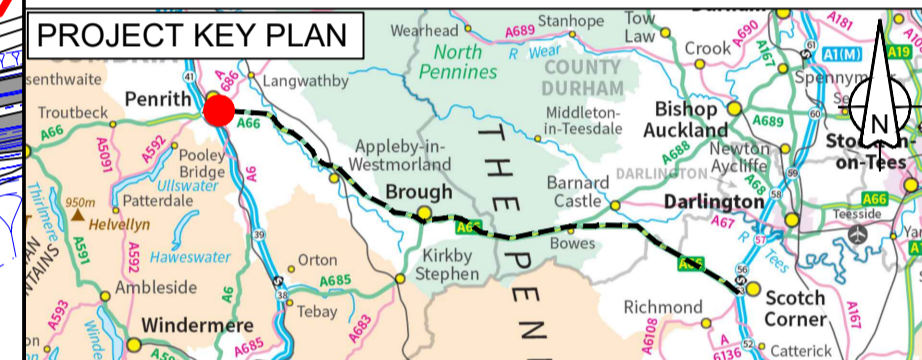

C01	ASCO	ASCO	JAS	DKID	SBAG
	14/11/22	14/11/22	14/11/22	14/11/22	14/11/22
Revision details					
Revision	Created	Checked	Reviewed	Approved	Authorised
	dd/mm/yy	dd/mm/yy	dd/mm/yy	dd/mm/yy	dd/mm/yy

Purpose  
Response to ExA's Procedural Decision PD-006 in Rule 6 Letter

PINS Reference Number  
TR010062

Client  
3 Piccadilly Place  
Manchester  
M1 3BN

Project Name / Scheme Name  
**A66 Northern Trans-Pennine Project  
Scheme 0102  
M6 Junction 40 to Kemplay Bank**

Drawing Title  
**General Scheme Outline Plans  
Submitted in response to PD-006  
Sheet 1 of 2**

Project Ref. No.	Stage	Scale:	@ A1
---	PCF3	1:2500	
		Dimensions:	M

Drawing Number	Project	Originator	Volume
HE565627	- AMY -	HAC -	
S0102	-DR-CH-	000003	
Location	Type	Role	Number

Suitability	Suitability Description	Revision
A	Approved for Stage Complete	C01

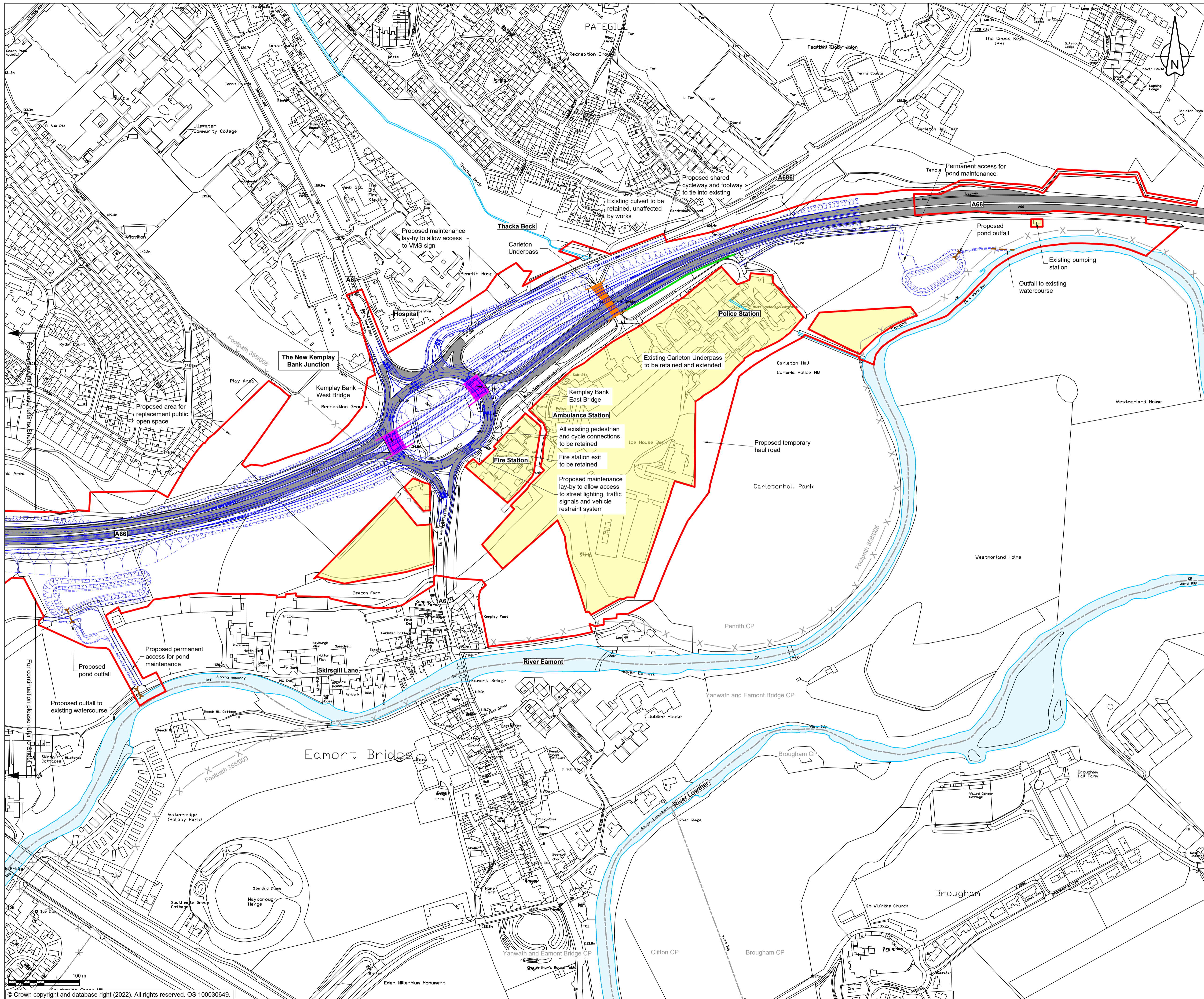

- ### NOTES
1. ALL DIMENSIONS ARE IN METRES UNLESS NOTED OTHERWISE.
  2. FOR ENVIRONMENTAL DETAILS REFER TO THE ENVIRONMENTAL MASTERPLAN AND ASSOCIATED DRAWINGS/DOCUMENTS.
  3. THE DESIGN OF THE SCHEME IS SHOWN HERE FOR ILLUSTRATIVE PURPOSES ONLY AND WILL BE SUBJECT TO DETAILED DESIGN DEVELOPMENT IN ACCORDANCE WITH THE PROVISIONS OF THE DEVELOPMENT CONSENT ORDER.
  4. THESE PLANS SHOULD BE READ IN CONJUNCTION WITH RIGHTS OF WAY AND ACCESS PLANS.

- ### KEY
- ORDER LIMITS
  - AREA EXCLUDED FROM ORDER LIMITS
  - AREA OF OUTSTANDING NATURAL BEAUTY (AONB)
  - EXISTING WATERCOURSE
  - EXISTING A66 CARRIAGEWAY
  - PARISH BOUNDARY
  - EXISTING PUBLIC RIGHT OF WAY
  - PROPOSED WORKS
  - PROPOSED EARTHWORKS
  - PROPOSED CULVERT & HEADWALL
  - PROPOSED RETAINING STRUCTURE
  - PROPOSED BRIDGE / VIADUCT
  - PROPOSED UNDERPASS / TUNNEL

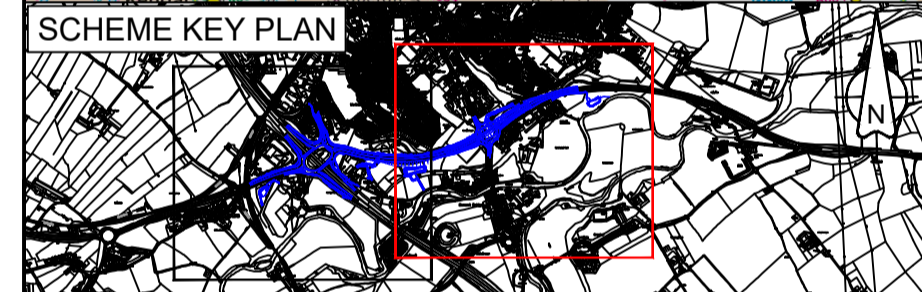
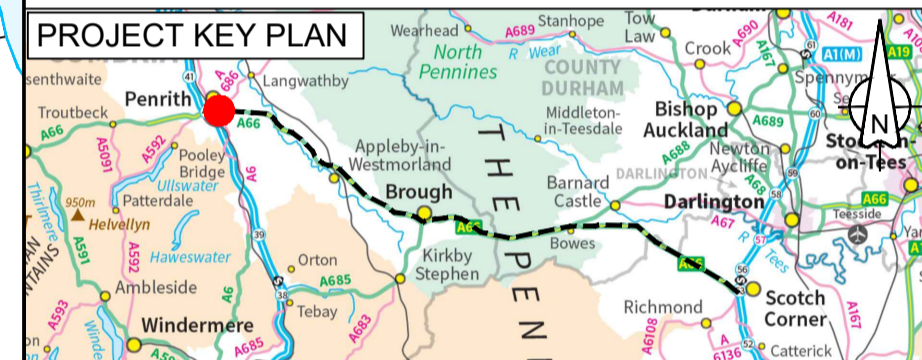

C01	ASCO	ASCO	JJAS	DKID	SBAG
	14/11/22	14/11/22	14/11/22	14/11/22	14/11/22
Revision details					
Revision	Created	Checked	Reviewed	Approved	Authorised
	dd/mm/yy	dd/mm/yy	dd/mm/yy	dd/mm/yy	dd/mm/yy

Purpose  
Response to ExA's Procedural Decision PD-006 in Rule 6 Letter

PINS Reference Number  
TR010062

Client  
3 Piccadilly Place  
Manchester  
M1 3BN

Project Name / Scheme Name  
**A66 Northern Trans-Pennine Project  
Scheme 0102  
M6 Junction 40 to Kemplay Bank**

Drawing Title  
**General Scheme Outline Plans  
Submitted in response to PD-006  
Sheet 2 of 2**

Project Ref. No.	Stage	Scale	@ A1
---	PCF3	1:2500	
		Dimensions	M

Drawing Number	Project	Originator	Volume
HE565627 - AMY - HAC -			
S0102	-DR-CH-	100002	
Location	Type	Role	Number

Suitability	Suitability Description	Revision
A	Approved for Stage Complete	C01